

NEEDLE-VALVES PN 400

The valves are of forged steel construction with butt weld ends.

Material:

Stainless steel

Body: AISI 316 L

Stem: AISI 329

Packing: Graphite

Handwheel: Steelplate

Pressure	400	160	125	20	bar
Temp	20	125	200	300	C

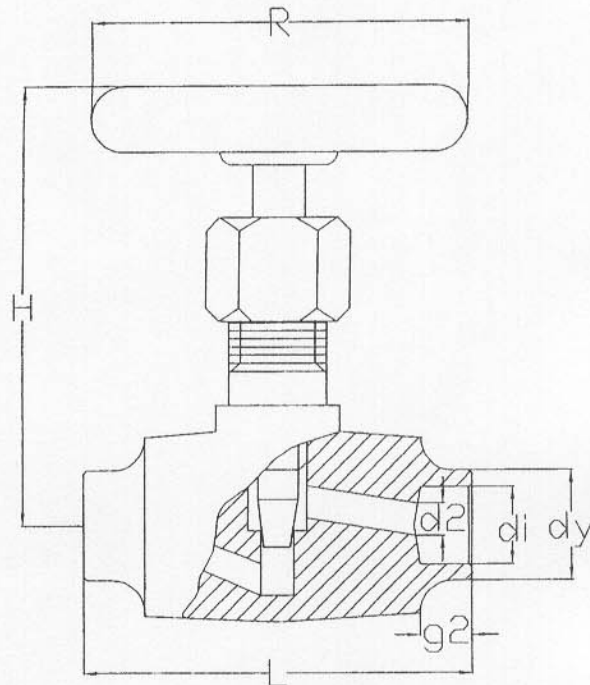

RSK	DN	Measure						
		di	dy	d2	g2	H	L	R
462 02 18	8	8,5	13,5	5	8	85	60	65
462 02 19	10	12,5	17,2	5	8	85	60	65
462 02 20	15	16	21,3	5	8	85	60	65
462 02 21	20	20	26,9	8	9	100	70	85
462 02 22	25	25	34	10	9	110	78	100

The valve can on request be supplied with locked boxnut and also with handwheel of AISI 316.

These valves are suitable for steam, oil and gas.

They are also available for a wide range of acid and alkaline fluids in chemical and processing industries.

Rubens
VERKSTAD AB

BOX 103, S-280 60 BROBY

PHONE +46 44 401 78 • FAX +46 44 408 51